

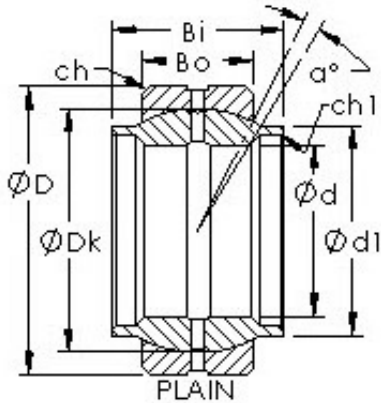

KFY MANUFACTURING MEXICO LIMITED



AST GEEW20ES plain bearings

Bearing No. GEEW20ES

| | |
|---|-----------------------------------|
| Bore Diameter | 20 mm |
| Outer Diameter | 35 mm |
| Bearing Type | plain |
| Bore Dia (d) | 20.0000 |
| Outer Dia (D) | 35.0000 |
| Outer Width (Bo) | 12.0000 |
| Inner Width (Bi) | 20.0000 |
| Dynamic Load Rating (Cr) | 30,000 |
| Static Load Rating (Cor) | 146,000 |
| Max. shaft corner radius, or 45 deg. chamfer (ch1) | 0.300 |
| Max. housing corner radius, or 45 deg. chamfer (ch) | 0.300 |
| Spherical Diameter (dk or Dk) | 29.000 |
| Mis-alignment Angle (a deg.) | 4 |
| Extended Inner OD (d1) | 25.000 |
| Weight (g) | 69.00 |
| Material | 52100 Chrome steel, or equivalent |

GEEW20ES Bearing 2D drawings and 3D CAD models