

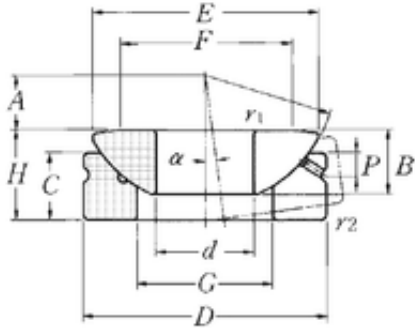

KFY MANUFACTURING MEXICO LIMITED

40 mm x 105 mm x 27 mm NTN SAT40 plain bearings



Bearing No. SAT40

Size	40x105x27 mm
Bore Diameter	40 mm
Outer Diameter	105 mm
Width	27 mm
d	40 mm
D	105 mm
B	27 mm
C	22 mm
H	32 mm
P	9 mm
r1 min.	0,6 mm
r2 min.	1 mm
A	24,5 mm
E	98 mm
F	78 mm
G	59 mm
Angle	5 °
Weight	1,64 Kg
Basic dynamic load rating (C)	365 kN

SAT40 Bearing 2D drawings and 3D CAD models