

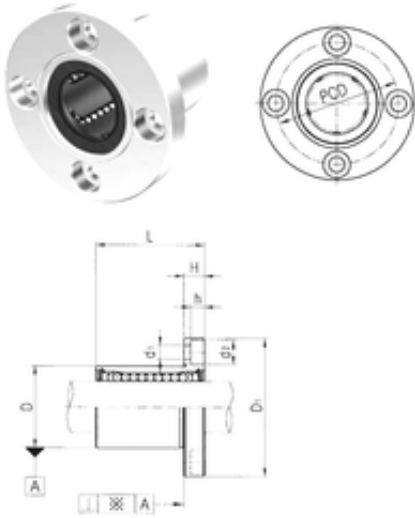

KFY MANUFACTURING MEXICO LIMITED



LMEF25 Bearing 2D drawings and 3D CAD models

Samick LMEF25 linear bearings

Bearing No. LMEF25

| | |
|--------------------------------|----------|
| Bore Diameter | 25 mm |
| Outer Diameter | 40 mm |
| d | 25 mm |
| D | 40 mm |
| d1 | 5,5 mm |
| d2 | 9,5 mm |
| h | 5,4 mm |
| D1 | 62 mm |
| H | 8 mm |
| L | 58 mm |
| PCD | 51 mm |
| Tolerance perpendicularity (C) | 15 |
| Weight | 0,335 Kg |
| Basic dynamic load rating (C) | 0,98 kN |